

13 - FLOUR MILL & ROASTERY

PUBLIC HEALTH DEPARTMENT

RASAL KAIMAH, _____

TOTAL AREA = 72.00 Sq.M / 774.72 Sq.FT

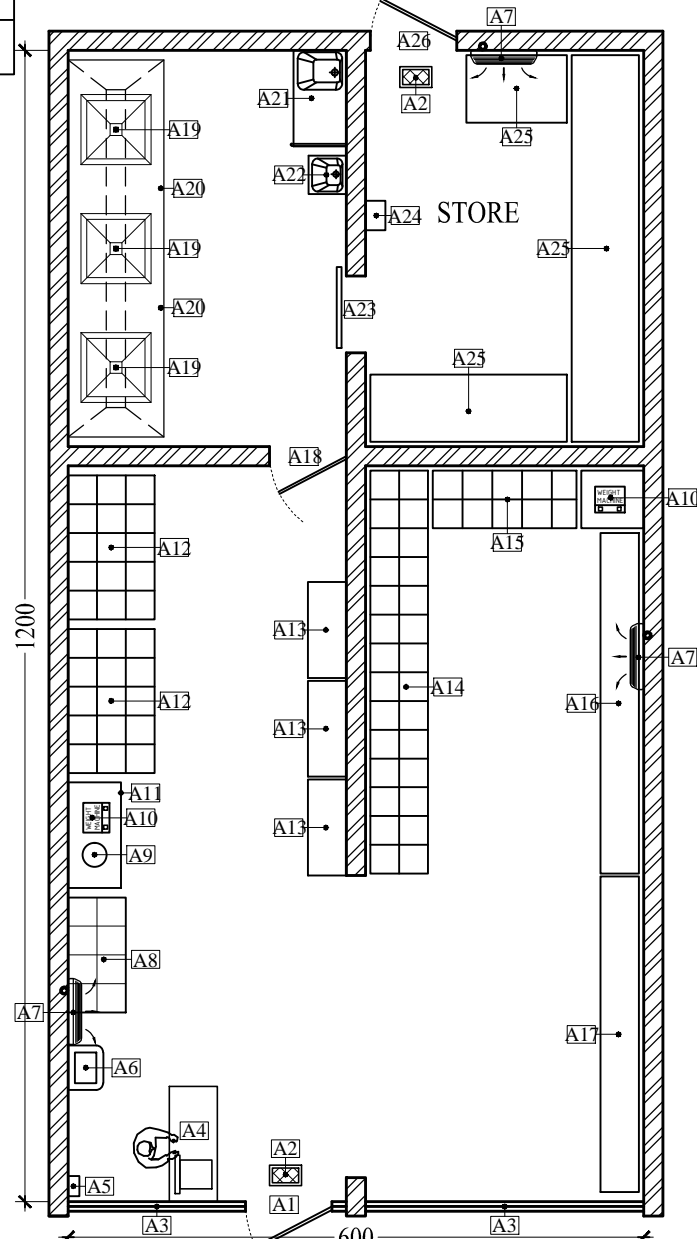

THIS LAYOUT IS DESIGNED AS A STANDARD MODEL. IN CASE OF ANY DIMENSIONAL CHANGES, THE DECISION WILL BE TAKEN AFTER RISK ASSESSMENT RELATED TO THE ACTIVITY AND OPERATION TYPE.

LEGENDS

A1	MAIN DOOR
A2	INSECT KILLER
A3	FIXED GLASS
A4	CASH COUNTER WITH DELIVERY TABLE
A5	FIRST AID BOX
A6	GARBAGE BIN
A7	SPLIT A/C
A8	DISPLAY SHELVES FOR COFFEE ITEMS
A9	COFFEE GRINDER
A10	WEIGHTING MACHINE
A11	PACKING MATERIALS UNDER THE TABLE
A12	DISPLAY SHELVES FOR SPICES & PULSES
A13	RACK FOR SPICES
A14	DISPLAY SHELVES FOR SPICES & PULSES
A15	DISPLAY SHELVES FOR NUTS ITEMS
A16	DISPLAY SHELVES FOR SWEETS ITEMS
A17	RACK FOR NUTS ITEMS
A18	DOOR
A19	GRINDING MACHINE
A20	CHIMNEY HOOD WITH BLOWER EXHAUST FAN
A21	EQUIPMENT WASH
A22	STAFF HAND WASH
A23	DOOR TO STORE
A24	CHEMICAL STORE SHELF
A25	STORAGE SPACE FOR HOLDING ITEMS
A26	SERVICE EXIT / ENTRY

MODEL & STANDARD DESIGN OF FLOUR MILL & ROASTERY