

06 - SUPERMARKET

## PUBLIC HEALTH DEPARTMENT

RASAL KAIMAH,  
TOTAL AREA = 112.50 Sq.M / 1210.50 Sq.FT

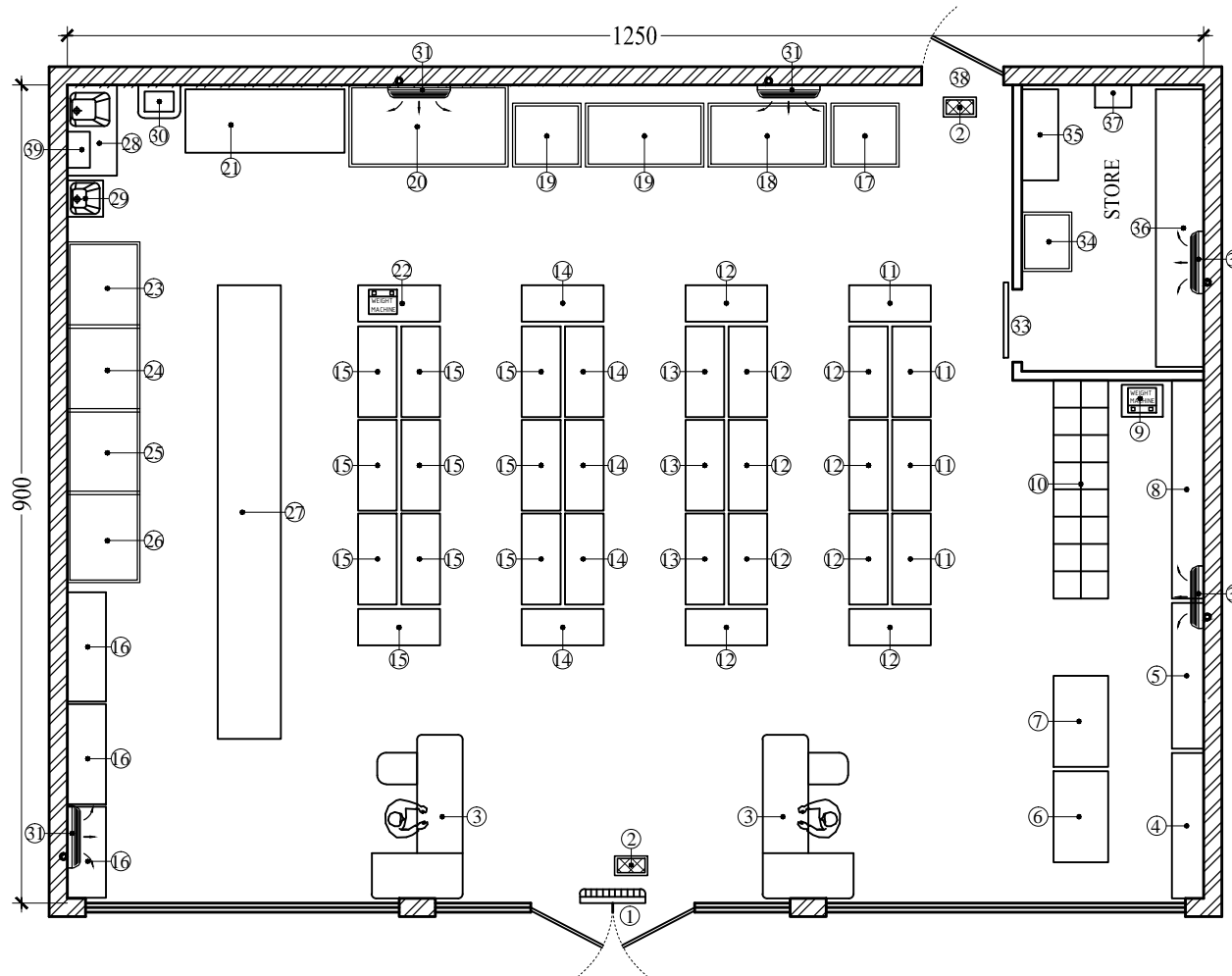

THIS LAYOUT IS DESIGNED AS A STANDARD MODEL.  
IN CASE OF ANY DIMENSIONAL CHANGES, THE -  
DECISION WILL BE TAKEN AFTER RISK ASSESSMENT  
RELATED TO THE ACTIVITY AND OPERATION TYPE.

MODEL & STANDARD DESIGN OF SUPERMARKET

### LEGENDS

1	ENTRANCE WITH AIR CURTAIN
2	INSECT KILLER
3	CASH COUNTER WITH DELIVERY TABLE
4	SHELVES FOR STATIONARY & PERFUMES
5	SHELVES FOR MOBILE & ACCESSORIES
6	SHELVES FOR WATCHES & ELECTRONICS
7	SHELVES FOR MOBILE & ACCESSORIES
8	SHELVES FOR CHOCOLATES
9	WEIGHING MACHINE
10	SHELVES FOR NUTS & SPICES ITEMS
11	RACK FOR STATIONARY ITEMS
12	RACK FOR COSMETIC ITEMS
13	RACK FOR HOUSE HOLD ITEMS
14	RACK FOR CANDY, BAKERY & BISCUIT ITEMS
15	RACK FOR FOOD ITEMS
16	RACK FOR DETERGENT & NON FOOD ITEMS
17	FREEZER FOR ICE CREAMS
18	CHILLER FOR JUICE, MILK, & DAIRY ITEMS
19	CHILLER FOR JUICE, SOFT DRINKS & WATER ITEMS
20	CHILLER FOR VEGETABLES & FRUITS
21	DISPLAY STAND FOR VEGETABLES & FRUITS
22	PACKING TABLE WITH WEIGHING MACHINE
23	FREEZER FOR CHICKEN ITEMS
24	FREEZER FOR FROZEN VEGETABLES
25	FREEZER FOR MEAT ITEMS
26	FREEZER FOR FISH ITEMS
27	PALLET FOR HOLDING ITEMS
28	S. S. SINK FOR WASHING VEGETABLE & FRUITS
29	STAFF HAND WASH
30	GARBAGE BIN
31	SPLIT A/C
32	STAND FOR HOLDING ITEMS
33	DOOR TO STORE
34	CHILLER FOR EXPIRY DATE ITEMS
35	STAND FOR EXPIRY DATE ITEMS
36	STAND FOR HOLDING ITEMS
37	CHEMICAL STORE SHELF
38	SERVICE EXIT / ENTRY
39	FIRST AID BOX