

VETERINARY LABORATORY

# PUBLIC HEALTH DEPARTMENT

RAS AL KAIMAH, -----

TOTAL AREA = 39.44 Sq.M / 424.37 Sq.FT

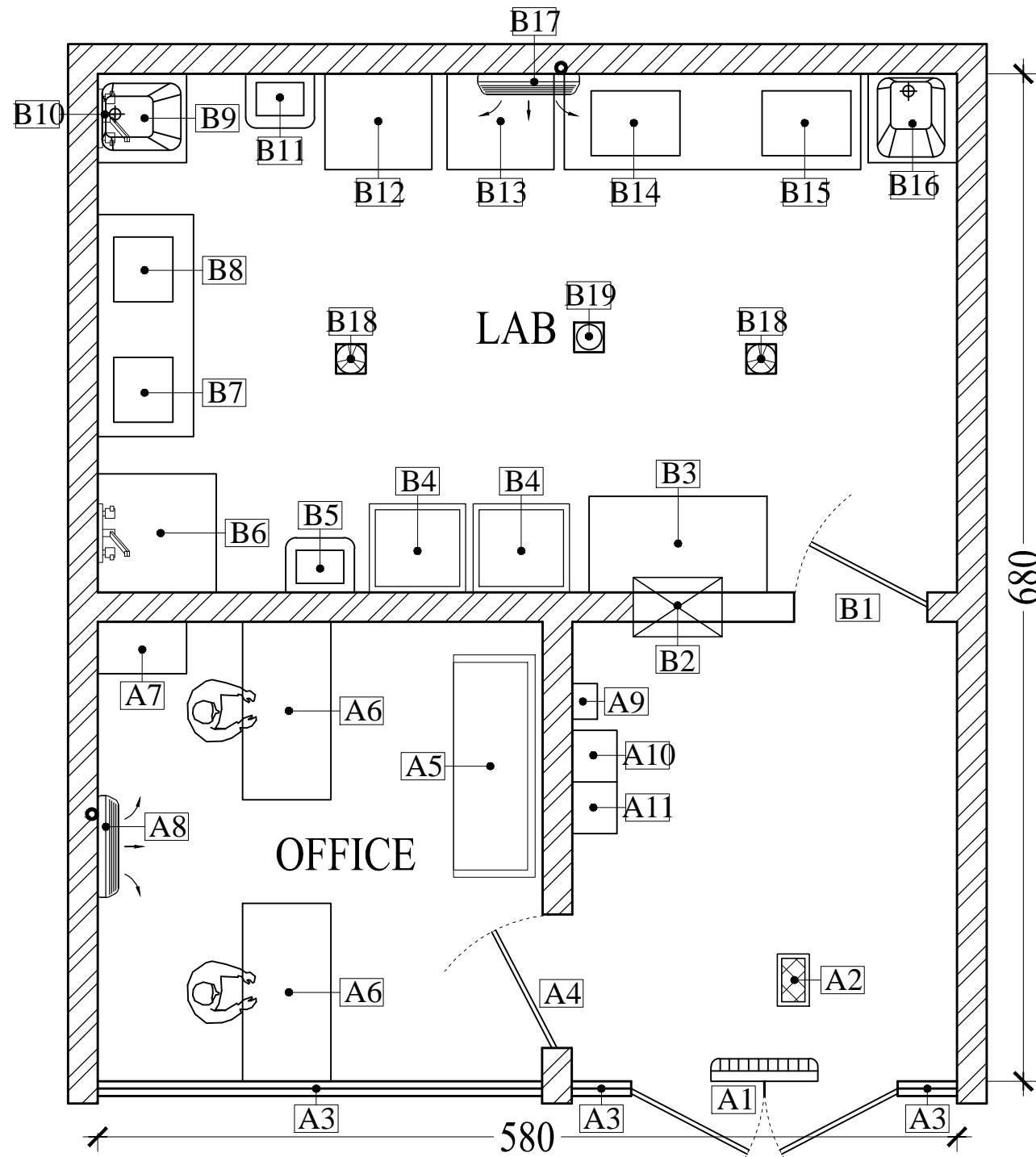

MODEL LAYOUT FOR VETERINARY LABORATORY

THE PROVIDED LAYOUT MODEL SERVES AS A - REFERENCE; ENSURE THE NEW LAYOUT - CONFORMS TO THE SPECIFIC PREMISE - DIMENSIONS AND REQUIREMENTS.

## LEGENDS

ENTRANCE & OFFICE (A)	A1	ENTRANCE WITH AIR CURTAIN
	A2	INSECT KILLER
	A3	FIXED GLASS
	A4	DOOR TO OFFICE
	A5	WAITING AREA
	A6	OFFICE TABLE
	A7	FILE CABINET
	A8	SPLIT A/C
	A9	FIRST AID BOX
	A10	CHEMICAL STORE SHELVES
	A11	SANITATION LOCKER
LAB (B)	B1	DOOR TO LAB
	B2	RECEIVING WINDOW
	B3	LAB BENCHES
	B4	REFRIGERATOR
	B5	GARBAGE BIN (WITH PEDAL & WHEELS)
	B6	NON HAND OPERATED HAND WASH
	B7	MICROSCOPE
	B8	CENTRIFUGE
	B9	DIRTY SINK
	B10	HOT & COLD WATER SOURCE
	B11	BIOMEDICAL WASTE BIN
	B12	HEMATOLOGY ANALYZER - (BLOOD ANALYSER)
	B13	COBAS MACHINE
	B14	AUTOCLAVE MACHINE
	B15	CHEMISTRY ANALYSER
	B16	CLEAN SINK
	B17	SPLIT A/C
	B18	EXHAUST FAN
	B19	FLOOR GRATING