

PACKING & REPACKING

# PUBLIC HEALTH DEPARTMENT

RASAL KAIMAH,

AREA = 81.00 Sq.M / 871.56 Sq.FT

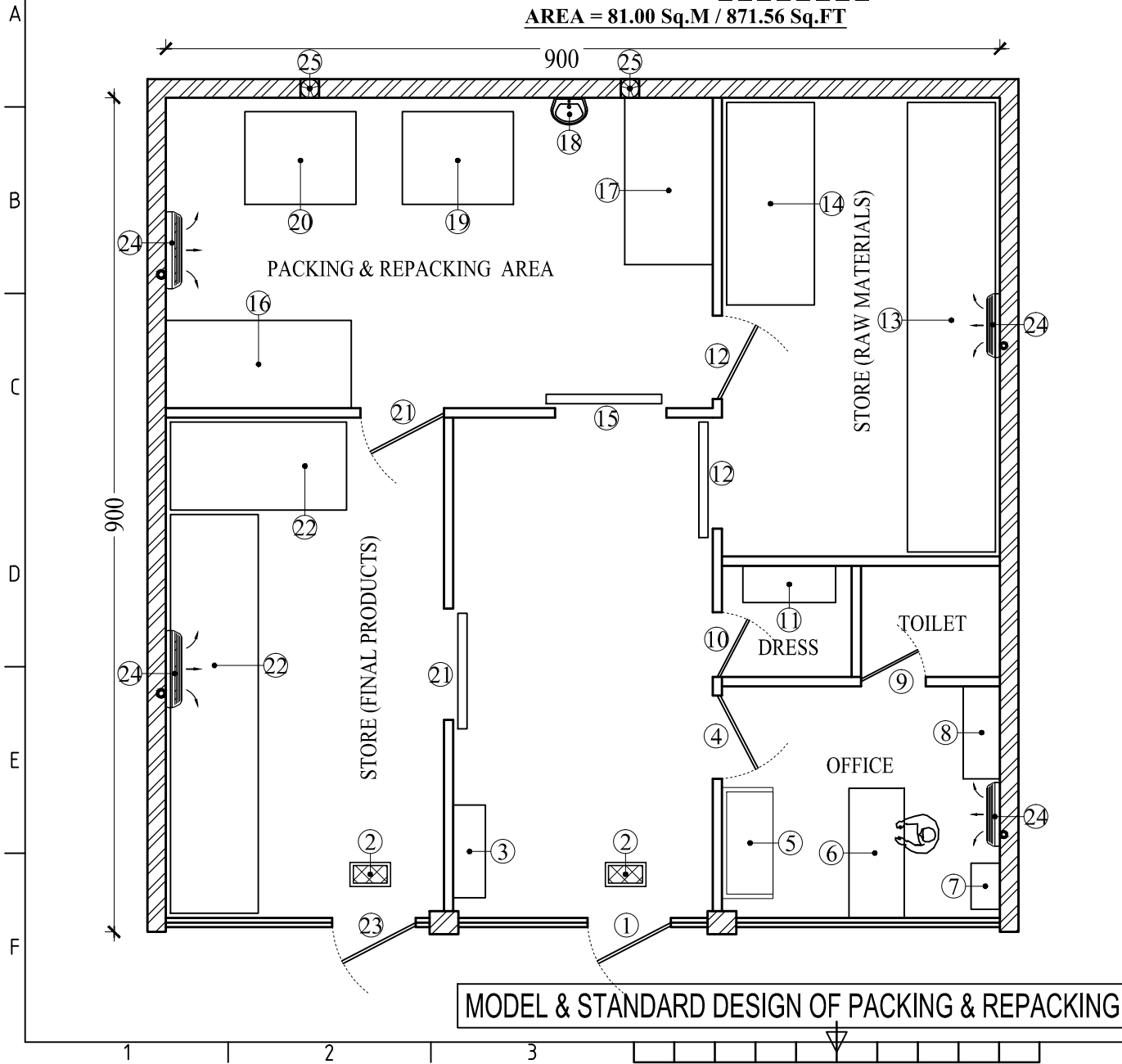

MODEL & STANDARD DESIGN OF PACKING & REPACKING

## LEGENDS

1	ENTRANCE
2	FIXED GLASS
3	CHEMICAL STORE SHELF
4	DOOR TO OFFICE
5	WAITING AREA
6	OFFICE TABLE
7	FIRST AID BOX
8	FILE CABINET
9	DOOR TO TOILET
10	DOOR TO DRESS ROOM
11	LOCKER
12	DOOR TO STORE (RAW MATERIALS)
13	STAND FOR HOLDING RAW MATERIALS
14	STAND FOR HOLDING PACKING MATERIALS
15	DOOR TO PACKING & MIXING AREA
16	PACKING TABLE
17	MIXING TABLE
18	HAND WASH
19	PACKING MACHINE
20	MIXING MACHINE
21	DOOR TO STORE (FINAL PRODUCTS)
22	STAND FOR HOLDING FINAL PRODUCTS
23	LOADING AREA
24	SPLIT A/C
25	EXHAUST FAN

THE PROVIDED LAYOUT MODEL SERVES AS A -  
REFERENCE; ENSURE THE NEW LAYOUT -  
CONFORMS TO THE SPECIFIC PREMISE -  
DIMENSIONS AND REQUIREMENTS.